

THE GROVE 

THE GROVE

Set in 300 acres of rolling Hertfordshire countryside just 18 miles from London, our idyllic country estate is the perfect hideaway for a creative event of any size. From the traditional 18th Century Mansion to the contemporary Cedar Suite, The Grove promises 28 bright, beautiful spaces, not forgetting the wonderfully verdant Walled Garden. And with use of up to 215 bedrooms, let your imagination run wild.



HOTEL INFORMATION

Local Train Stations

Watford Junction – 10 mins – 2 miles – 3 km
Watford High Street – 10 mins – 3 miles – 5 km
Watford Underground – 10 mins – 3 miles – 5 km
Watford North – 10 mins – 3 miles – 5 km

Local Airports

London Luton – 25 mins – 18 miles – 29 km
London Heathrow – 25 mins – 19 miles – 30 km
London Stansted – 50 mins – 45 miles – 72 km
London City – 1 hour – 45 miles – 72 km

Private Transport

On-site helipad, which must be pre-booked



FIND
US
HERE



LOCAL ATTRACTIONS

There's always plenty to do in lively Hertfordshire and The Grove is just a short drive from a variety of activities and attractions. Kids and adults alike will love exploring the wonders of the Wizarding World at the Warner Bros. Studio Tour – The Making of Harry Potter. London's closest indoor real snow slope, The Snow Centre, is also on our doorstep.

Watford Football Club

Warner Bros. Studio Tour

Snow Centre

Woodland Hawking

Cassiobury Park

Rex Cinema

Willow's Activity Farm

Natural History Museum, Tring

Ashridge Estate

Whipsnade Zoo, Dunstable

Holland & Holland Shooting Ground

Knebworth Gardens



ACTIVITIES

GROUNDS

Whether it's by foot or bike, discover the 300 acres that we call home. The Walled Garden promises an oasis of tranquillity, complete with biodiverse Gemma's Kitchen Garden, whilst the Formal Gardens — as the name would suggest — offer perfectly manicured grounds. For those looking to venture a little further afield, there's also beautiful woodland and the Grand Union Canal on our doorstep.

HOTEL

When the British weather doesn't deliver, there's still plenty to see and do inside. Enjoy a good book or admire the artwork over a coffee in the Lounges or Library, indulge in a cocktail or two at The Glasshouse Bar or — if you're a sports aficionado — head over to The Stables to watch a live game with a refreshing drink.

ACTIVITIES

There are all manner of outdoor pursuits available year-round, including bike rides, archery, tennis and even laser clay shooting. During school holidays, we also offer a range of sports-based and crafting activities.

FACILITIES

Our expansive estate is not only home to bars, restaurants and lounges, we also have OFSTED-registered Anouska's Kids Club on-site as well as an 18 hole championship golf course and award-winning Sequoia spa.

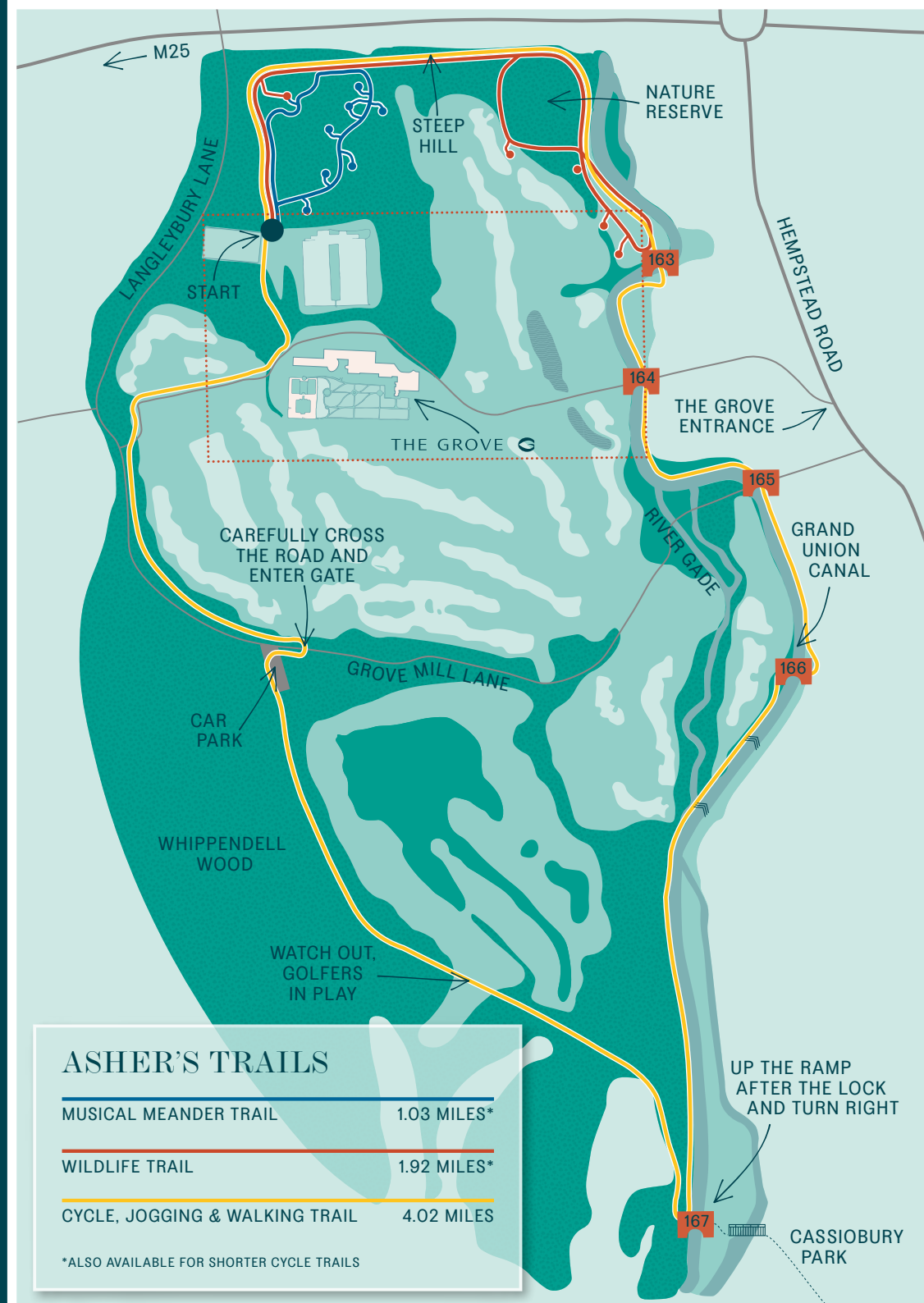

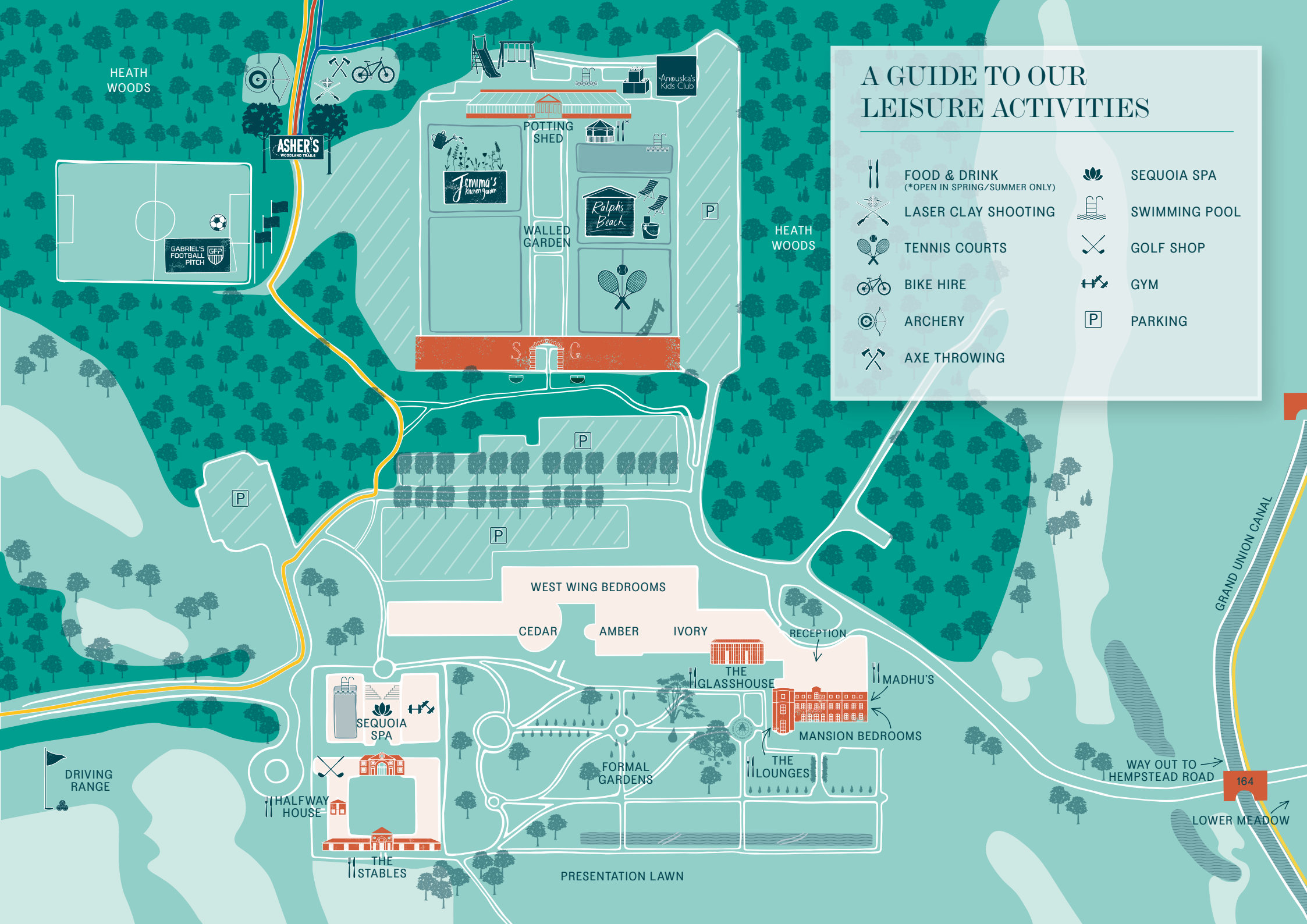

A GUIDE TO OUR LEISURE ACTIVITIES

- | | | | |
|---|---|---|---------------|
|  | FOOD & DRINK
(*OPEN IN SPRING/SUMMER ONLY) |  | SEQUOIA SPA |
|  | LASER CLAY SHOOTING |  | SWIMMING POOL |
|  | TENNIS COURTS |  | GOLF SHOP |
|  | BIKE HIRE |  | GYM |
|  | ARCHERY |  | PARKING |
|  | AXE THROWING | | |

HEATH WOODS

ASHER'S
WOODLAND TRAILS

GABRIEL'S
FOOTBALL
PITCH

POTTING
SHED

Jemma's
Children's Garden

WALLED
GARDEN

Ralph's
Beach

HEATH WOODS

S G

WEST WING BEDROOMS

CEDAR

AMBER

IVORY

RECEPTION

THE GLASSHOUSE

MADHU'S

MANSION BEDROOMS

THE LOUNGES

FORMAL GARDENS

PRESENTATION LAWN

SEQUOIA SPA

HALFWAY HOUSE

THE STABLES

DRIVING RANGE

WAY OUT TO
HEMPSTEAD ROAD

GRAND UNION CANAL

LOWER MEADOW

164

ACTIVITIES & TEAM BUILDING

18 hole golf course
Team building activities
Swimming
Bike rides
Archery
Laser clay shooting
Full-size football pitch
Tennis
Horse riding
Falconry displays
Outdoor games in the Walled Garden
Beach volleyball
Indoor games in the Potting Shed





DINING

International live cooking stations at
The Glasshouse

British classics redefined at The Stables

South Asian dishes at Madhu's at The Grove

Sushi and Asian dishes at The Lounges

Pop-up Italian restaurant Verde Kitchen
in the Potting Shed

Bespoke dining experiences can be arranged,
including BBQs in the Walled Garden





UNWINDING

Newly refurbished Sequoia spa featuring a
22m swimming pool, jacuzzi, wellness pool,
experience showers and sauna and steam rooms
Bamford and Natura Bissé restorative treatments

State of the art gym, featuring the latest
Technogym equipment

Various classes, including yoga and pilates







GOLF

The Grove, home to one of the UK's most prestigious golf courses, has welcomed many greats of the game, having staged a World Golf Championship event, won by Tiger Woods in 2006, as well as hosting the British Masters in 2016.

Open to all who love the game, there is no membership policy however regular players can take advantage of our Clarendon Collection. We're excited to be launching an impressive new piece of technology to our golf practice facilities: TrackMan Range.



TRACKMAN GOLF

Experience a whole new way to practice at The Grove with Trackman Range, a revolutionary ball-tracking solution.

It's the flexible golf ball tracking solution featuring Tour-proven technology. Whatever your golfing experience, simply download the app ahead of your visit and you'll unlock a wealth of game-enhancing features, including detailed shot analysis, interactive experiences, and entertaining games, all to revolutionise your warm-up experience. 3D rendering within the app also replicates the finest details and features of the practice range, making for the most realistic and complete player experience.

How does it work?

Multiple radars will be placed around our driving range that tracks the flight of every ball. This automatically identifies from which bay the ball has been hit and sends the data straight back to the Trackman Range app on your mobile phone.

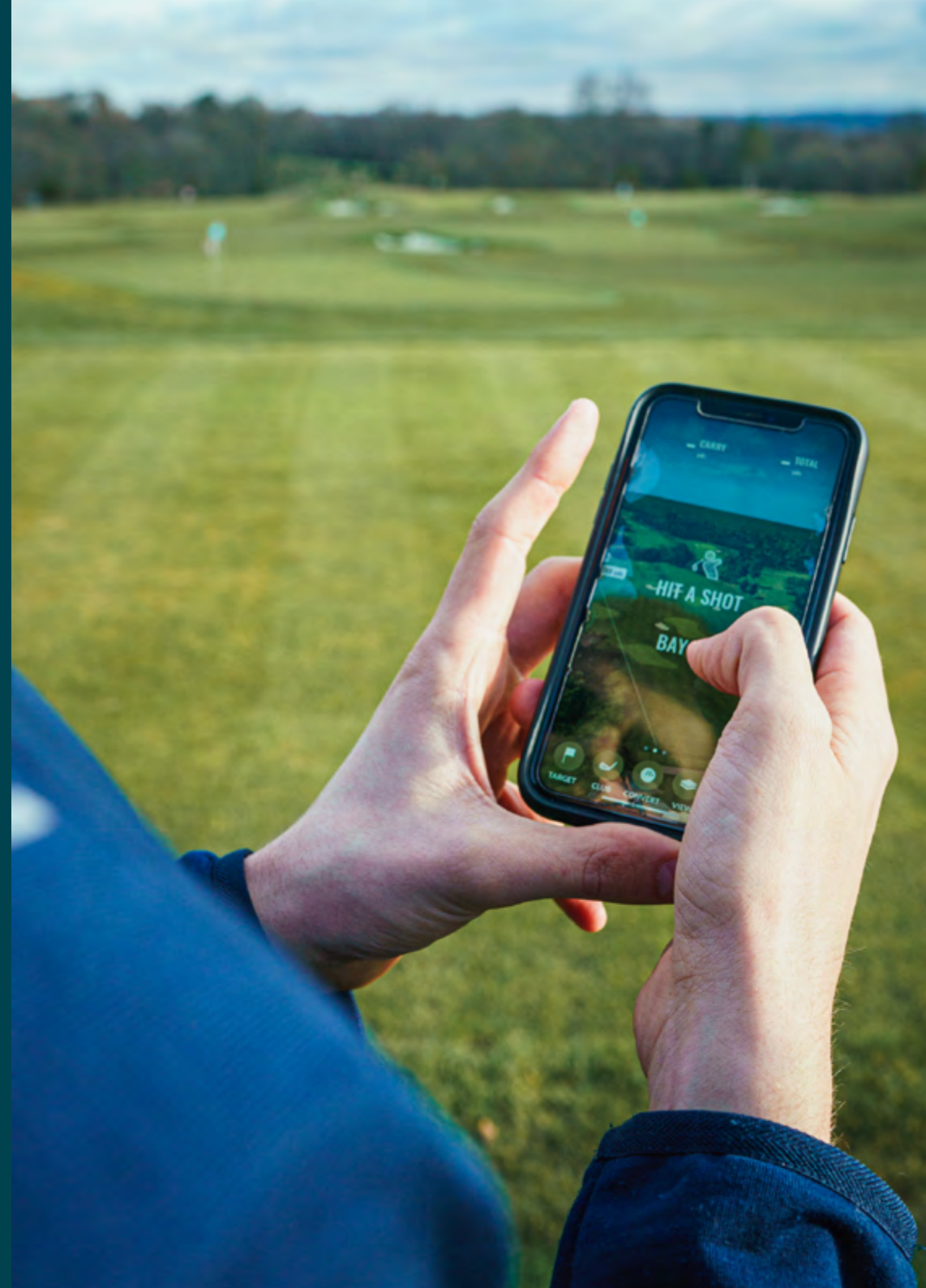

GROUP GOLF

Corporate Golf | Society Golf

Spend your next away day walking in the footsteps of Tiger Woods, Barack Obama and other notable Golfing guests on our championship golf course – hosts of the American Express World Golf Championship and the Sky Sports British Masters, hosted by Luke Donald. With both corporate and society golf packages available, as well as the addition of personalised merchandise and instruction, we'll help you organise a day out that everyone will remember.

Your Group Golf Experience

Our team are renowned for delivering first-class golf days for both companies and societies, no matter the size. With a dedicated event planner to cover every detail in advance and impeccable service on the day of your event, enjoy a perfect golf day at The Grove.



Corporate Golf Days

Take it offline and on to the course. A corporate day out at The Grove is so much more than a round on our championship course. From personalised merchandise to branding opportunities, delicious dining options to your own tournament coordinator, we've got it covered.

Society Golf Days

Looking for a challenge for your next society day? Plan a unique event to enjoy with your fellow golfers.

Society Packages are available:

Monday – Sunday from November – April
Saturday and Sunday during May – October



Player's Lounge

Make full use of our luxury Players Lounge for speeches, dinners and private events. With stunning floor-to-ceiling windows and easy access to The Stables courtyard, it's the perfect spot to enjoy a meeting, team building activity or a group dinner after your round.

Overview

The original stable block at The Grove was once frequented by George Stubbs, the 18th century artist, who took inspiration from the fine mares and stallions.

Today, the horses have been replaced by the golf carts and the horseshoe's have given way to soft spikes! Lovingly restored, The Stables is home to a bar, restaurant and Players Lounge.

The purpose-built Players Lounge provides a unique space for golfers to gather following a day on the golf course and has been designed to bring 'the outside in', with the centre panels on each side sliding back during the warmer summer months to allow guests full access to The Stables courtyard area.



Player's Lounge Capacity

Lunch or dinner – 100 pax

Boardroom – 80 pax

Square – 48 pax

U-Shape – 40 pax

The Stables Restaurant

Lunch or dinner – 90 pax

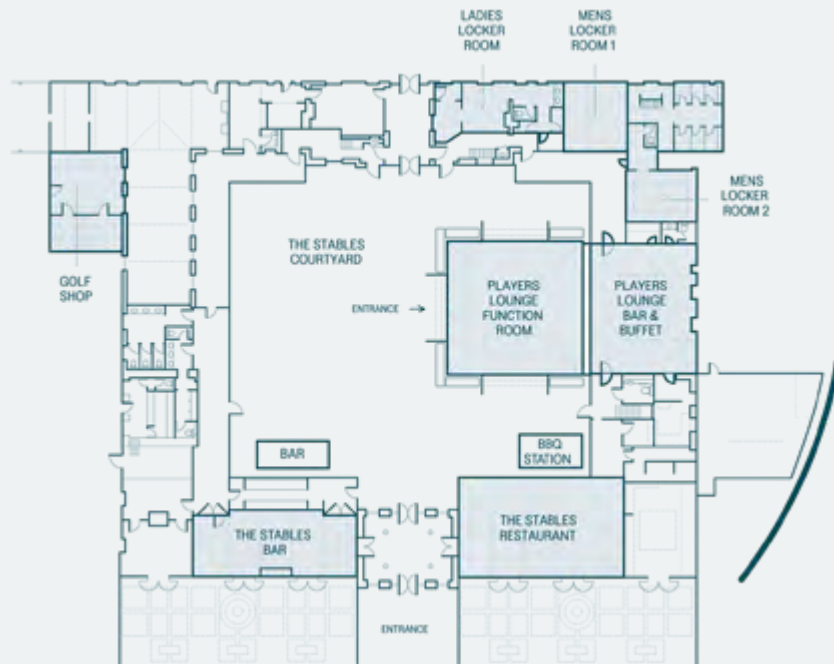



FOOTBALL ESCAPES

A first-class football coaching course with former Premier League players and UEFA coaches.

Football Escapes provide premier football coaching courses for children, courtesy of current and ex-professional footballers.

The two night breaks include sessions at Gabriel's football pitch with the above as well as...

Breakfast at The Glasshouse

Asher's Woodland Trails by foot, bike or segway*

Outdoor pursuits, including archery and laser clay shooting*

Use of our championship golf course*

Access to the facilities at our award-winning Sequoia spa**

Use of Anouska's Kids Club*

*There is a supplementary fee for these activities and facilities

**Adults and children over the age of 16 only. Children aged 12+ can use our children's swim times of 3-5pm.



MEETINGS AND EVENTS

We have 16 flexible event spaces and offer a range of inspiring and relaxing packages to engage your guests before, during and after your event.

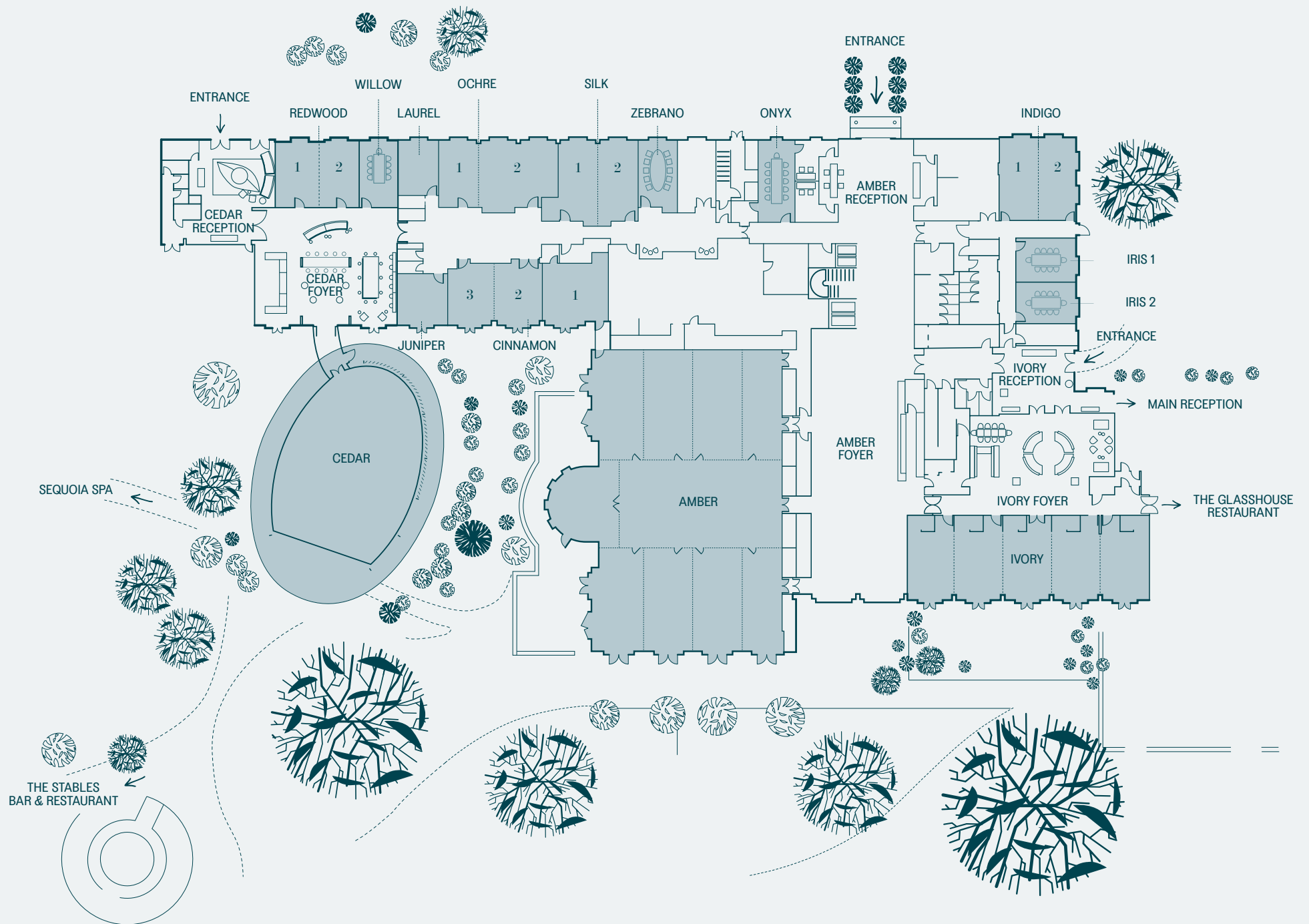



AMBER

Enjoy a stand out event in the largest of our luxury event spaces.



The Amber Suite is a blank canvas that can be used to host large events or divided into up to nine sections for smaller events, making it the ideal venue for conferences, board meetings, weddings and celebrations. Spanning 520m² of space, its dedicated entrance, private foyer and panoramic views make it a spectacular choice for any event.

Key Features

- Ground floor location
- Vehicular access area
- Dedicated entrance with registration desk
- Private reception area with in-built bar
- Divisible into 9 rooms
- 2 drop down screens
- In-built PA system
- In-built projector in rooms 2/3, 4 & 6/7
- 2 x 3 phase 63amp separate feed (room 1)
- 1 x 3 phase 63amp separate feed (room 5)
- Pin spotting
- Private terrace

DIMENSIONS

Area	521.5sqm
Height	3.9m to 4.7m
Length	29.56m
Width	17.63m

SET-UPS

Theatre	450*
Classroom	300*
Boardroom	78
U-shape	78
Cabaret	256
Reception	700
Lunch/Dinner	480
Dinner dance	420
Seated buffet	330
Standing buffet	500
Exhibition	36 stands of 3x2m

*front projection

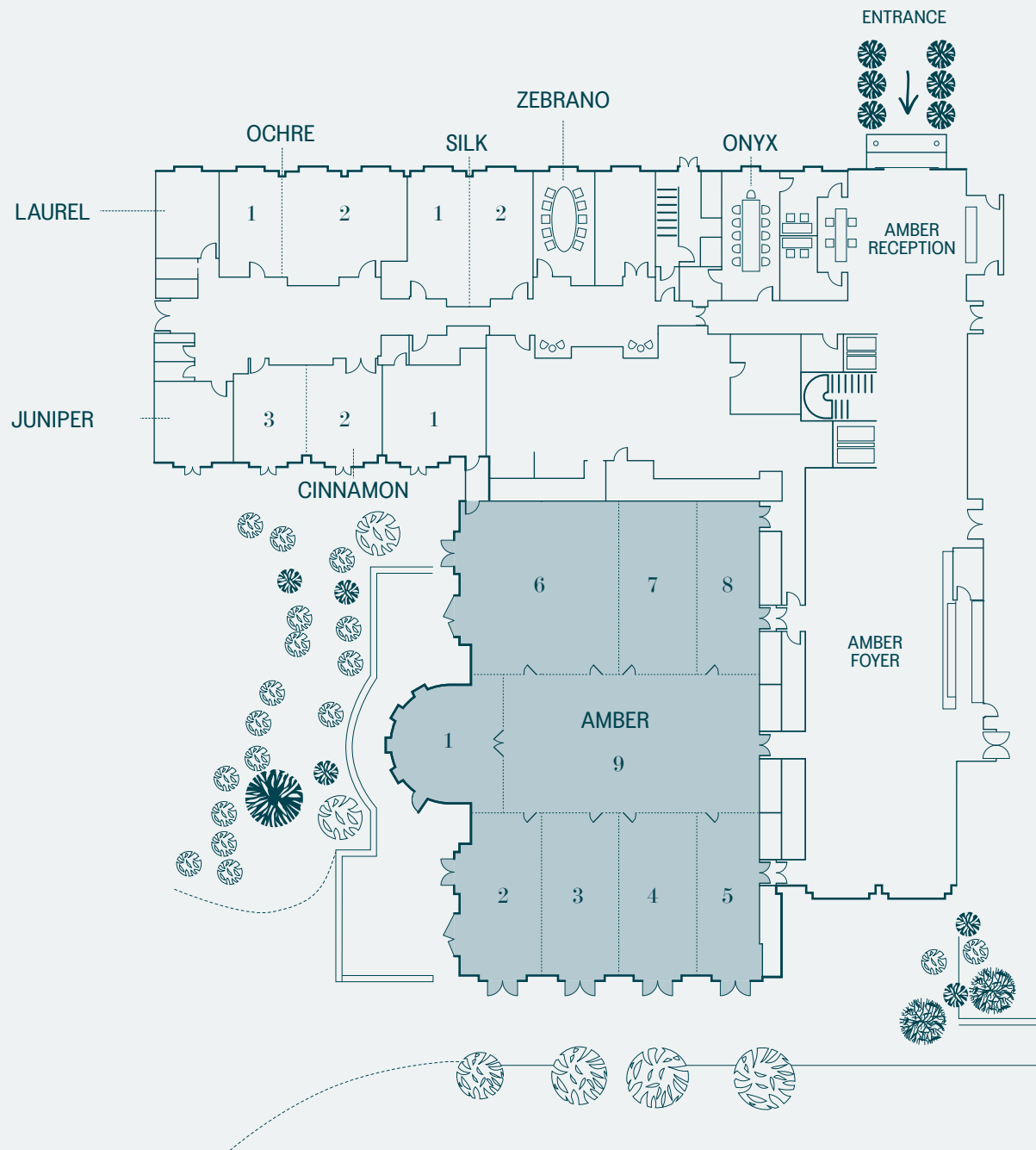







CEDAR

Our bright and airy Cedar Suite brings the outside in, with its natural sunlight and nature themed decor.



Designed by luxury interiors guru Martin Hulbert, the space offers a 180 degree view over our stunning formal gardens and comes with a private entrance and foyer, as well as three spacious meeting rooms and breakout spaces.

Named after the 200-year-old trees in our grounds, this flexible venue is perfect for meetings, events and lavish private parties.



Key Features

- Ground floor location
- Dedicated entrance with registration desk
- Private reception area with in-built bar
- 3 phase power
- 85 inch LED screen
- Data projector and drop down screen
- LED lighting and pin spoting
- Private terrace

DIMENSIONS

Area	205.4sqm
Height	3.33m
Length	15.74m
Width	13.05m

SET-UPS

Theatre	166
Classroom	96
Boardroom	60
U-shape	48
Cabaret	84
Reception	200
Lunch/Dinner	168
Dinner dance	110
Seated buffet	100
Standing buffet	175
Exhibition	17 stands

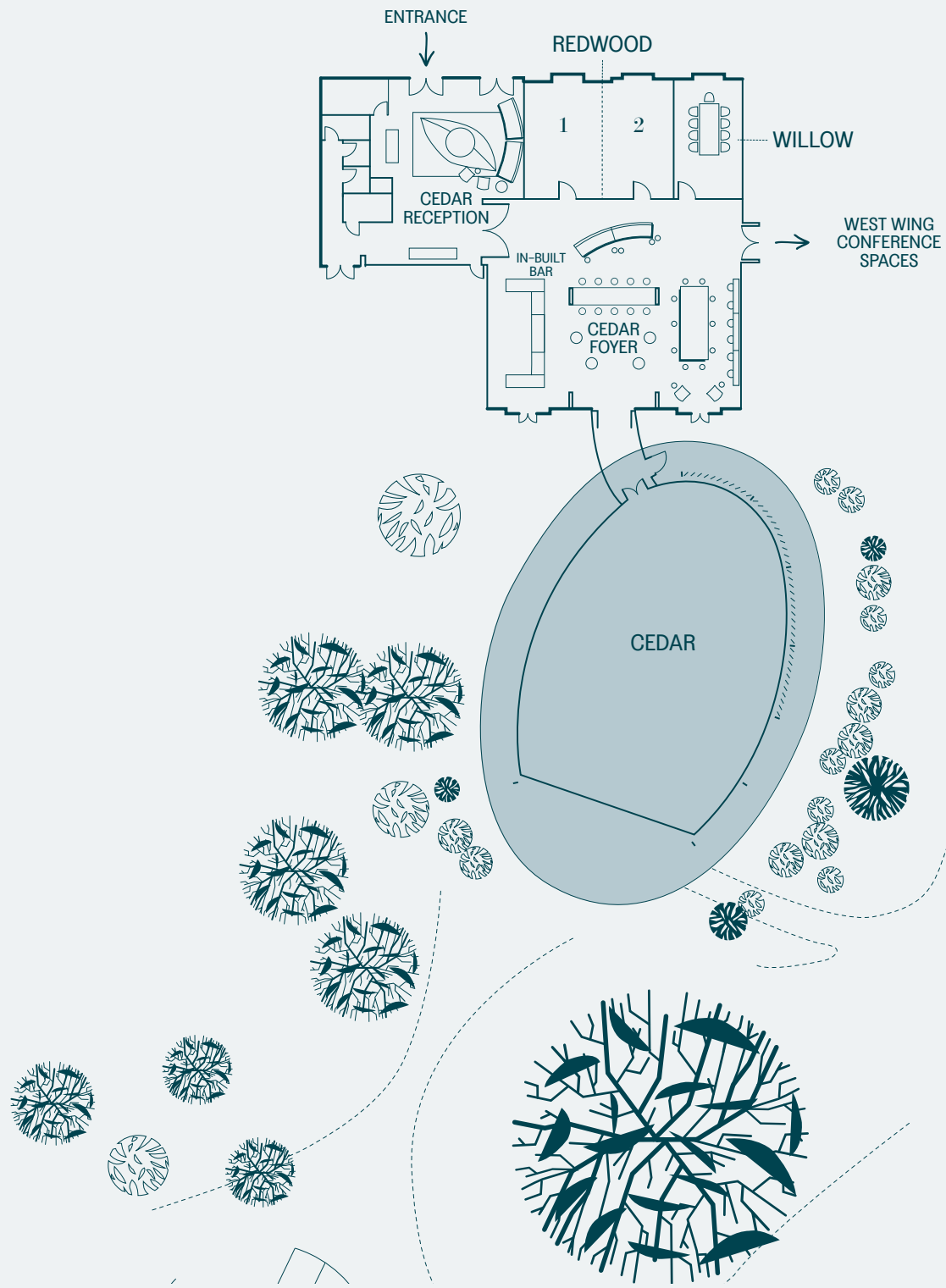



IVORY

A flexible, contemporary
space set at the heart
of the hotel.

With a private entrance and terrace, the space is
perfect for medium-sized meetings and parties.

Boasting natural daylight and direct access
to our formal gardens, these unique function
rooms can be broken down into five sections to
accommodate smaller groups.



Key Features

- Ground floor location
- Dedicated entrance with registration desk
- Private reception area with in-built bar
- Divisible into 5 rooms
- LED screens in rooms 1, 2, 4 & 5
- In-built PA system
- 2 drop down screens
- In-room dimmer controls
- Private terrace

DIMENSIONS

Area	132.24sqm
Height	2.9m to 3.4m
Length	23.2m
Width	5.7m

SET-UPS

Theatre	120*
Classroom	60*
Boardroom	60
U-shape	64
Cabaret	64
Reception	150
Lunch/Dinner	120
Dinner dance	80
Seated buffet	80
Standing buffet	150
Exhibition	8 stands of 3x2m

*front projection

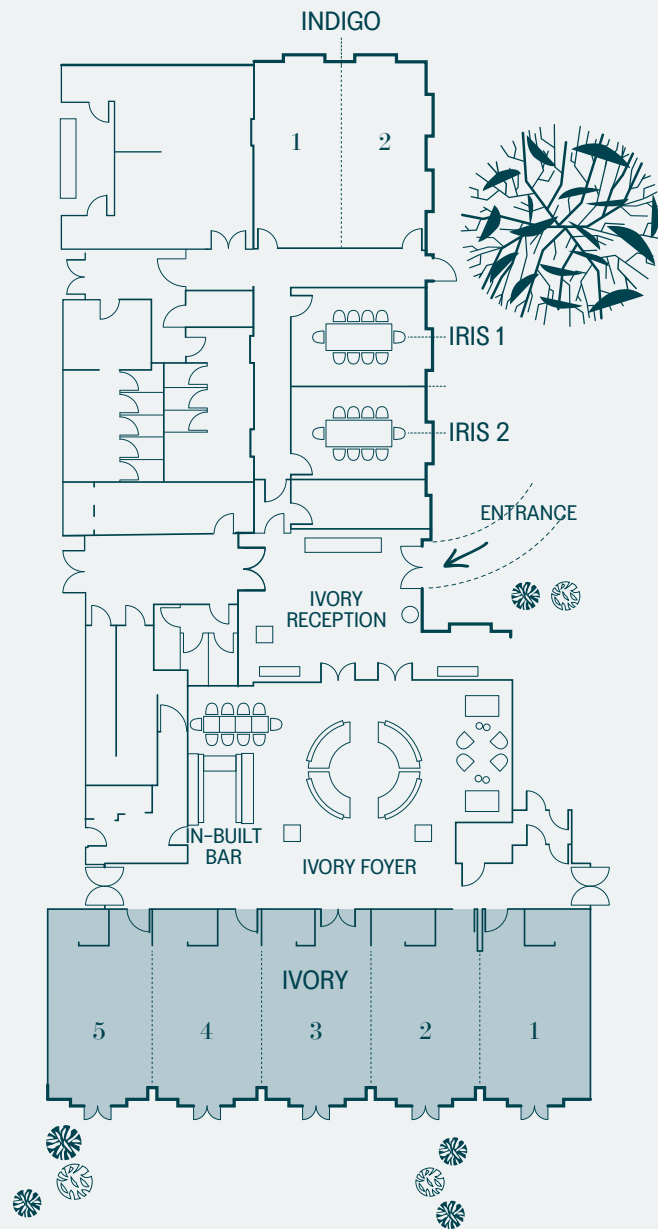

THE POTTING SHED

A hidden gem, our rustic Potting Shed is located inside our gated Walled Garden.

Situated in our stunning Victorian Walled Garden, the Potting Shed promises a setting unlike any other.

A beautifully restored Victorian glasshouse, the Potting Shed is the perfect mix of shabby chic and a wonderful space for a reception, summer cocktail party or evening barbecue. Its capacity can be increased with the addition of a marquee.





Key Features



- Ground floor location
- Spectacular glass ceiling
- Private, gated entrance
- 3 phase power
- 4 interlinking rooms
- Views of the Walled Garden
- Outdoor space, suitable for marquee

DIMENSIONS

Area	247.5sqm
Height	1.7m to 3.4m
Length	55m
Width	4.5m

SET-UPS

Reception	150
Lunch/Dinner	70
Dinner dance	60
Seated buffet	60
Standing buffet	100



WALLED GARDEN

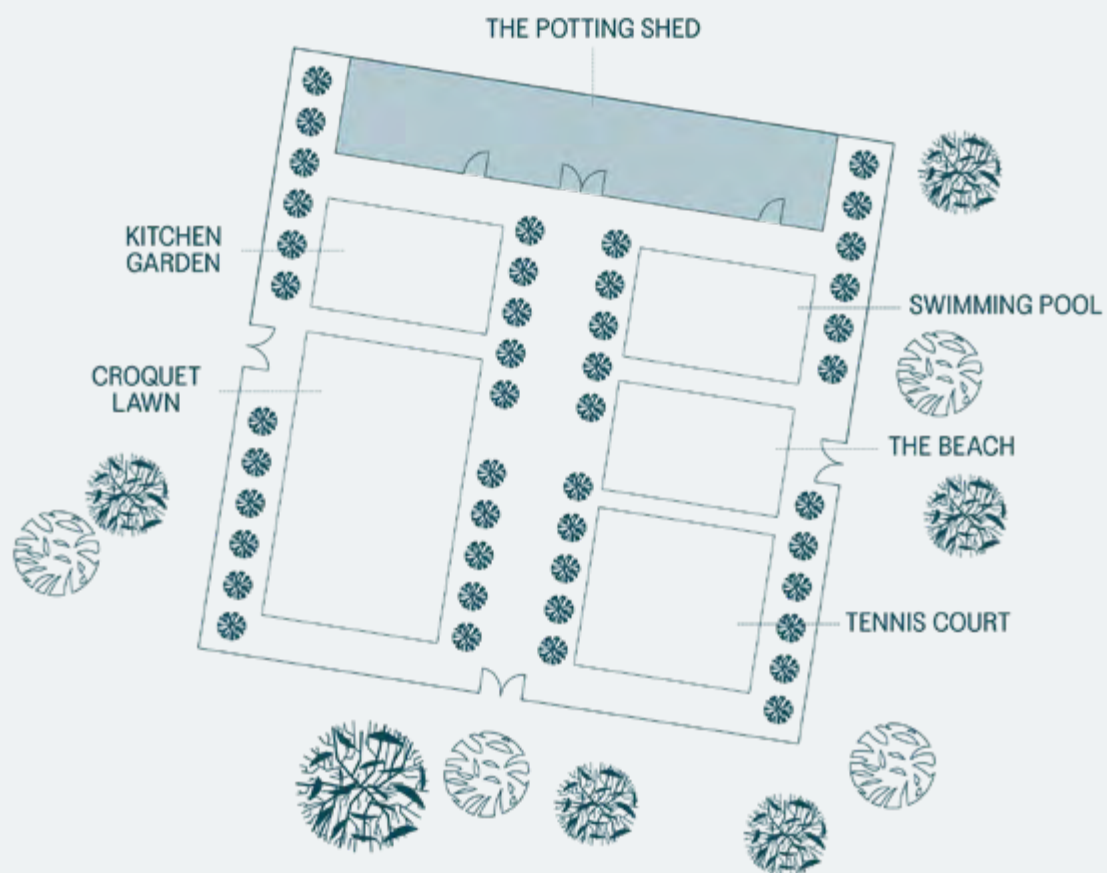

Area	13,048sqm
Length	116.5m
Width	112m

The Beach

Area	13,048sqm
Length	116.5m
Width	112m

Croquet Lawn

Area	684sqm
Length	18m
Width	38m
Marquee Build	Up to 600 people

Tennis Courts

Area	1,120sqm
Length	35m
Width	32m

Swimming Pool

Length	25m
Width	10m



SMALL MEETING ROOMS

Breakout spaces with
lots of natural daylight and
a contemporary design.

Our meeting rooms feature natural daylight,
boardroom tables and whiteboard walls –
perfect for creative brainstorming.

Whether it's a private group of executives or
a break out from a larger conference, we'll make
sure you have everything you need for your mini
meet-up. Groups can also use these smaller
rooms as breakout spaces during a larger event.



CINNAMON



With its private entrance, terrace and access to the gardens, the contemporary Cinnamon room is also a fantastic choice for small to medium-sized private events.

KEY FEATURES

Ground floor location

Divisible into 3 rooms

LED screen

In-built projector

Tungsten Halogen lights

In-room dimmer controls

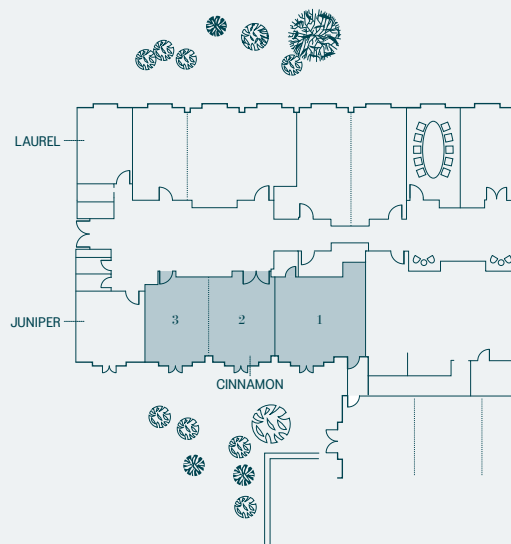

DIMENSIONS

Area	92.34sqm
Height	2.9m to 3.4m
Length	17.1m
Width	5.4m

SET-UPS

Theatre	100*
Classroom	42*
Boardroom	40
U-shape	35
Cabaret	48*
Reception	120
Lunch/Dinner	70
Dinner dance	50
Seated buffet	50
Standing buffet	100
Exhibition	6 stands of 3x2m

*front projection

SILK & OCHRE



The perfect partners can be used together or apart depending on your needs. Ideal for smaller conferences, presentations, board meetings, or private dining and celebrations.

KEY FEATURES

Ground floor location

Divisible into 3 rooms

LED screen

In-built projector

Tungsten Halogen lights

In-room dimmer controls

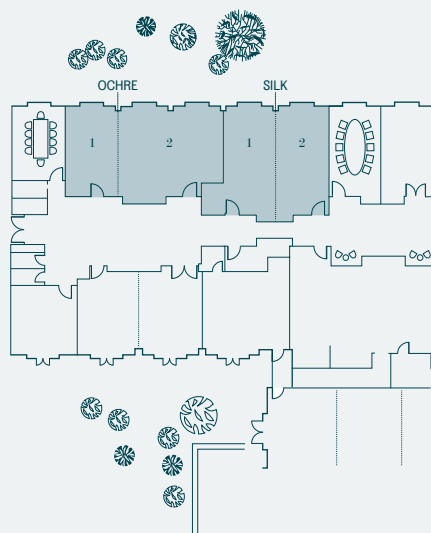

DIMENSIONS

	Silk	Ochre
Area	42sqm	54.72sqm
Height	2.9 to 3.4m	2.9 to 3.4m
Length	5.6m	4.8m
Width	7.5m	11.4m

SET-UPS

Theatre	42	48
Classroom	20	30
Boardroom	16	28
U-shape	12	27
Cabaret	20	24
Reception	56	72
Lunch/Dinner	30	40
Seated buffet	20	30
Standing buffet	30	40

INDIGO & IRIS



Ideally located for the Ivory Suite, these purpose built breakout spaces feature whiteboard walls, natural daylight and in room technology.

KEY FEATURES

Ground floor location

Indigo is divisible into 2 rooms

LED screen

Wall hanging flip charts

Iris 1 and 2 have fixed boardroom tables

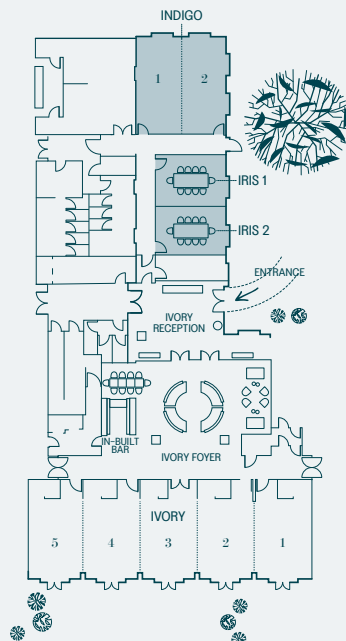

DIMENSIONS

	Indigo	Iris
Area	61.37sqm	20.93sqm
Height	2.9m	2.9m
Length	7.96m	5.26m
Width	7.71m	3.98m

SET-UPS

Theatre	50	
Classroom	24	
Boardroom	18	9
U-shape	20	
Cabaret	32	
Reception	56	
Lunch/Dinner	48	
Seated buffet	40	
Standing buffet	50	

REDWOOD & WILLOW



Bright and contemporary rooms which are located off the Cedar Foyer, ideal for office and breakout space for The Cedar Suite.

KEY FEATURES

- Ground floor location
- Redwood is divisible into 2 rooms
- LED screen
- Whiteboard walls
- Wall hanging flip charts
- Willow has a fixed boardroom table

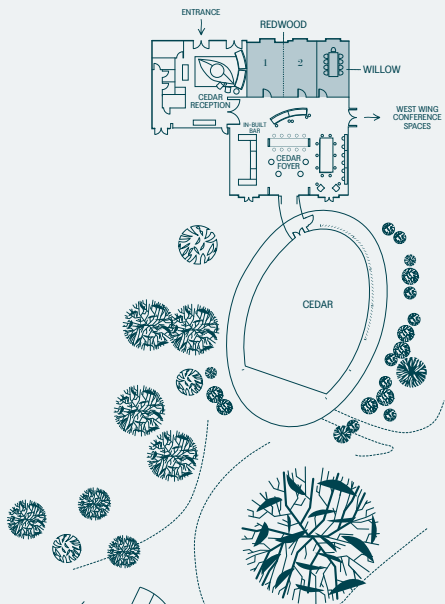

DIMENSIONS

	Redwood	Willow
Area	43.63sqm	22.1sqm
Height	2.9m	2.9m
Length	5.66m	6.28m
Width	7.71m	3.52m

SET-UPS

Theatre	40	
Classroom	18	
Boardroom	18	9
U-shape	18	
Cabaret	18	
Reception	40	
Lunch/Dinner	24	
Seated buffet	24	
Standing buffet	40	

LAUREL & JUNIPER



Two centrally located breakout spaces with lots of natural daylight and a contemporary design. With in-built LED's, these rooms are ideal for small breakout sessions.

KEY FEATURES

Ground floor location

LED screen

Wall hanging flip charts

Juniper has a garden terrace

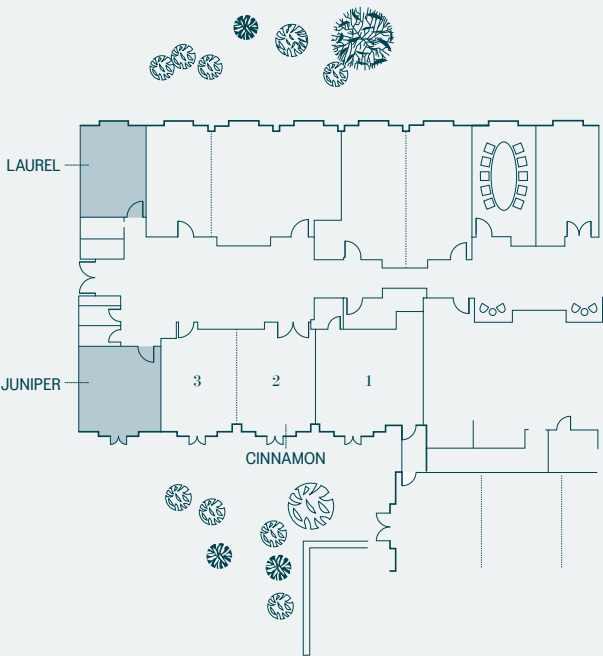

DIMENSIONS

	Laurel	Juniper
Area	19.63sqm	21.7sqm
Height	2.9m	2.9mm
Length	5.41m	4.91m
Width	3.63m	4.42m

SET-UPS

Theatre	12	12
Boardroom	10	10

ZEBRANO & ONYX



When you need to host a small meeting or simply escape from the larger events of the day, these bright and airy rooms offer the perfect venue for some focused meeting time.

KEY FEATURES

Ground floor location

Onyx is accessible from Amber reception

LED screen

Whiteboard walls

Fixed boardroom tables in both Zebrano and Onyx

Tungsten Halogen lights

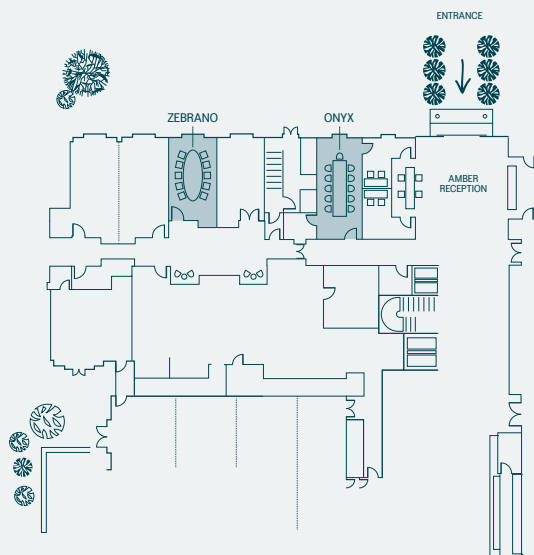

DIMENSIONS

	Zebrano	Onyx
Area	19.44sqm	22.26sqm
Height	2.9m to 3.4m	2.9m
Length	5.4m	6.53m
Width	3.6m	3.41m

SET-UPS

Boardroom	10	11
Lunch/Dinner	10	



MANSION

Elegant unique spaces
for small to medium
sized events.



With character aplenty, the 18th Century Mansion promises a series of elegant spaces for small to medium sized events. Choose from the Donneraile, Garden Room or Colette's, all of which offer sophisticated decor with panoramic views across the grounds and gardens, perfect for events or celebrations which demand a backdrop that is just a little bit special.

Key Features



Ground floor location

Grade II listed Mansion

High ceilings

Large windows

Views over the golf course

Private terrace

DIMENSIONS

	The Garden Room	Donneraile
Area	51.6sqm	60.6sqm
Height	4.3m	4.79m
Length	8.6m	10.1m
Width	6.5m	6.45m

SET-UPS

Theatre	16	
Boardroom	14	24
U-shape	12	22
Reception	28	28
Lunch/Dinner	28	28
Seated buffet	20	
Standing buffet	30	

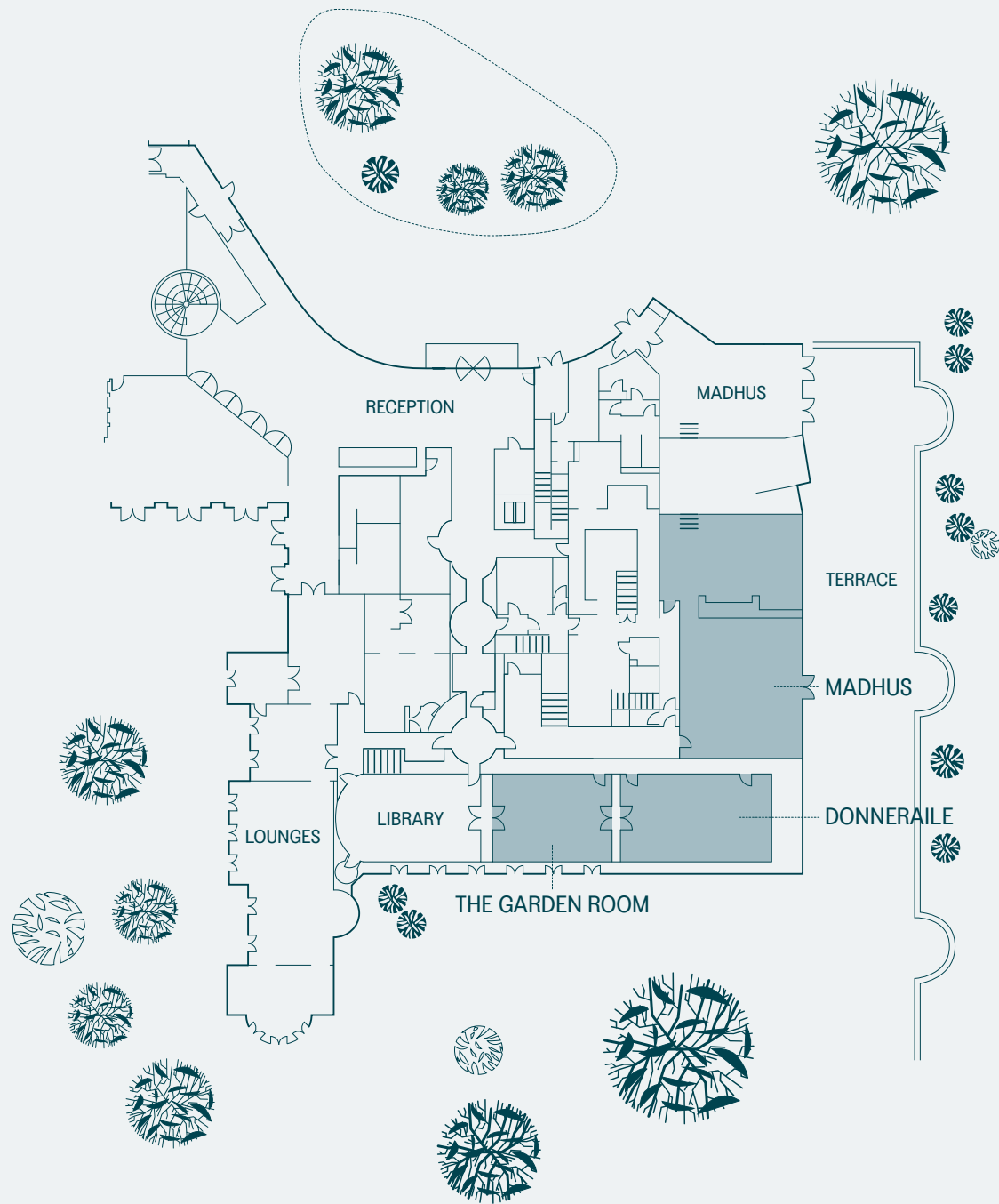

3D VIRTUAL TOURS

Experience The Grove
through 3D virtual tours.



Step into The Grove through virtual tour technology
which accurately depict our event spaces, rooms and
suites with 3D captured imagery.

Take a tour of our event spaces and rooms
by clicking the links below:

EVENT SPACES

[The Grove Event Space](#)

[Amber Suite](#)

[Cedar Suite](#)

[Ivory Suite](#)

ROOMS

[West Wing Classic](#)

[Deluxe West Wing – Olive](#)

[Deluxe West Wing – Terracotta](#)



WEST WING

In close proximity to
The Stables, Sequoia spa
and the golf course, our
contemporary West Wing
was recently refurbished
and promises:

Total of 189 West Wing Rooms

116 Classic Rooms

73 Deluxe Rooms

35 Deluxe Rooms with a partial garden view

38 Deluxe Rooms with a garden view



Classic Room

West Wing | King or Twin

Our **Classic rooms** are small but perfectly formed, best for those who prefer to spend their time relaxing at the spa, out on the golf course or exploring our 300 acre estate.

Room features include:

Mini Bar

Nespresso machine and tea making facilities

HD LED TV

Complimentary high speed Wifi

Air Conditioning

ESPA Amenities

Bathrobe and slippers

Hairdryer

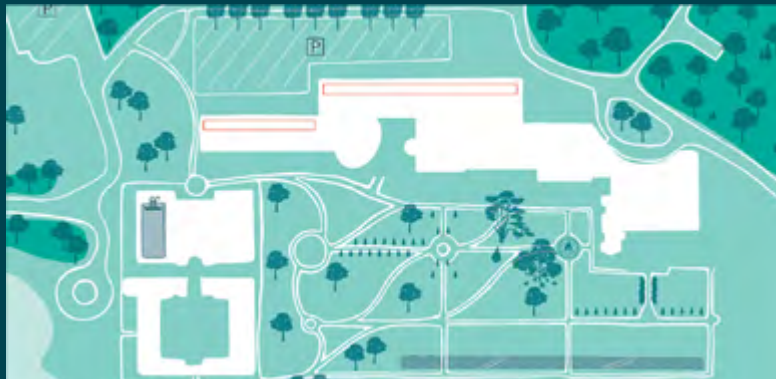



Superior Room

West Wing | King or Twin

Conveniently located just a short stroll from reception, our **Superior Rooms** offer everything our Classic Rooms do, with the addition of woodland views. Room features include:

- Mini Bar
- Nespresso machine and tea making facilities
- HD LED TV
- Complimentary high speed Wifi
- Air Conditioning
- ESPA Amenities
- Bathrobe and slippers
- Hairdryer



Deluxe Room

West Wing | King or Twin

Relax and unwind in one of our **Deluxe Rooms** with ample space inside and your own terrace or balcony outside, plus a bathroom with a freestanding roll top bath. Room features include:

- Mini Bar
- Nespresso machine and tea making facilities
- HD LED TV
- Complimentary high speed Wifi
- Air Conditioning
- ESPA Amenities
- Bathrobe and slippers
- Hairdryer

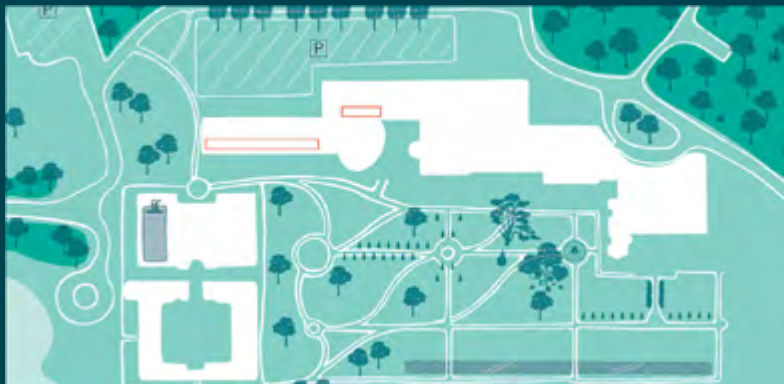



Garden View Room

West Wing | King or Twin

The best of the West Wing, our **Deluxe Rooms with Garden Views** – as the name suggests – offer uninterrupted views of the formal gardens and golf course beyond. Room features include:

- Mini Bar
- Nespresso machine and tea making facilities
- HD LED TV
- Complimentary high speed Wifi
- Air Conditioning
- ESPA Amenities
- Bathrobe and slippers
- Hairdryer





THE MANSION

With plenty of character and a distinctly boutique feel, our 18th Century Mansion is home to the recently refurbished Lounges and Library as well as:

7 Superior Rooms

10 Deluxe Rooms

5 Junior Suites

4 Suites – Earl, Villiers, Clarendon, The Grove



Mansion Superior Room

Mansion | King

Our **Mansion Superior Rooms** are filled with character and historic charm, making them an idyllic choice for a romantic getaway. Room features include:

- Mini Bar
- Nespresso machine and tea making facilities
- HD LED TV
- Complimentary high speed Wifi
- Air Conditioning
- ESPA Amenities
- Bathrobe and slippers
- Hairdryer



Mansion Deluxe Room

Mansion | King

Designed by Martin Hulbert, each of our **Mansion Deluxe Rooms** promise unique interiors and beautiful bathrooms. Room features include:

- Mini Bar
- Nespresso machine and tea making facilities
- HD LED TV
- Complimentary high speed Wifi
- Air Conditioning
- ESPA Amenities
- Bathrobe and slippers
- Hairdryer



Junior Suite

Mansion | King or Family

As well as complimentary Champagne on arrival and an amply stocked Mini Bar, our **Junior Suites** offer plenty of space to relax and unwind with loved ones. Room features include:

- Complimentary Mini Bar
- Nespresso machine and tea making facilities
- HD LED TV
- Complimentary high speed Wifi
- Air Conditioning
- ESPA Amenities
- Bathrobe and slippers
- Hairdryer
- Safe



Hyde Suite

Mansion | King or Family

By day, our **Hyde Suite** is flooded with light from the south facing gardens. By night, warm tones create a cosy atmosphere, perfect for both families and couples. Room features include:

- Complimentary Mini Bar
- Nespresso machine and tea making facilities
- HD LED TV
- Complimentary high speed Wifi
- Air Conditioning
- ESPA Amenities
- Bathrobe and slippers
- Hairdryer
- Safe



Villiers Suite

Mansion | King or Family

Perhaps the most opulent choice, our **Villiers Suite** is laden with deep burgundy tones, rich velvet and antique furniture. Room features include:

- Complimentary Mini Bar
- Nespresso machine and tea making facilities
- HD LED TV
- Complimentary high speed Wifi
- Air Conditioning
- ESPA Amenities
- Bathrobe and slippers
- Hairdryer
- Safe



The Clarendon Suite

Mansion | King or Family

The **Clarendon Suite** is light and airy with idyllic views of The Glasshouse terrace and formal gardens. Room features include:

- Complimentary Mini Bar
- Nespresso machine and tea making facilities
- HD LED TV
- Complimentary high speed Wifi
- Air Conditioning
- ESPA Amenities
- Bathrobe and slippers
- Hairdryer
- Safe



The Grove Suite

Mansion | King

Embodying the true spirit of The Grove, **The Grove Suite** boasts distinctive interiors, unique artwork and unparalleled views of our grounds. Room features include:

- Complimentary Mini Bar
- Nespresso machine and tea making facilities
- HD LED TV
- Complimentary high speed Wifi
- Air Conditioning
- ESPA Amenities
- Bathrobe and slippers
- Hairdryer
- Safe

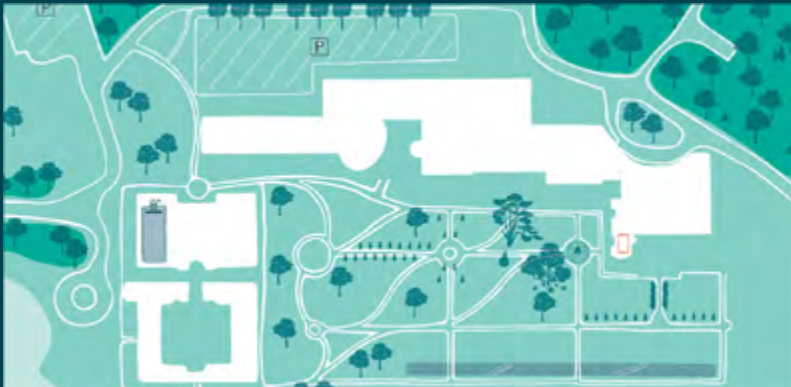



SUSTAINABILITY

By exploring and improving operational systems, developing the right internal culture and investing in new technologies, we aim to balance the environmental impact of our business with enhancing our guest experience and improving our business performance.

Wherever possible, environmentally sustainable products and services will be sourced locally and we encourage staff to communicate our commitment to environmental and social sustainability to our guests, suppliers, contractors, agents and wholesalers.



Sustainability Overview

The Grove is celebrating a series of sustainability-led wins on its golf course and across its extensive Hertfordshire grounds, having been awarded GEO Certified status and recently named 'Environmental Golf Course of the Year' at the Golf Environment Awards 2022. These accolades are a testament to the efforts made by the estate's gardeners, greenkeepers and grounds team.

Across the gardens and wider estate, sustainable efforts are continually applied, including the establishment of a rainfall compensation system that generates annual water savings of up to 30%, the creation of a new wetland area within the woodland, creating new environments for newts, frogs, water voles and dragonflies, and the ongoing investment in renewable energy programmes.

The estate team have also been collaborating with Hertfordshire & Middlesex Wildlife Trust to create areas of naturalised habitat, including River Gade chalk stream conservation, maintenance of native fescue grasses, and the introduction of wildflower areas.

In November of last year, The Grove's Gardens Team worked with volunteers to plant approximately **200 native trees on our Poppy Field**. This was thanks to the generous donation of trees and time from Watford Chambers of Commerce and their group Feeding Our Future who aimed to plant trees throughout Watford for The Queen's Green Canopy in honour of Her Majesty's Platinum Jubilee.



Jemima's Kitchen Garden

Our Gardens Supervisor, Abby Evans designed Jemima's Kitchen Garden and mapped out its permaculture ethos. Together with the Gardens team, she has transformed this corner of the Walled Garden.

As well as looking wildly beautiful, it provides endless homegrown fruit, veg and herbs for our chefs, ensuring we grow as much of our own produce as possible. It's made up of four quadrants including an amphitheatre sitting area for guests, trailing hops for our beer and a flow bee hive for honey on tap, making the garden more bee-friendly. South-facing fig trees provide shade for ponds in copper baths, each teeming with watercress, water mint, Lotus and Arrowheads that also provide a home for dragonflies and frogs for controlling pests.



The Grove Beer, Gin and Honey

THE GROVE BEER

Founded by the Three Brewers of St. Albans in 2017.

We're using four different varieties of hops called Fuggles (which is a very traditional popular hop), Northdown, Challenger and Cascade. They grow vertically in bines and are growing up at a fantastic rate.

We're brewing a Pale Ale and a Pilsner, which spends a little longer maturing. They're both very refreshing, light and fairly hoppy, and will be only available to purchase in bottles at The Grove. It'll be amazing for guests to enjoy the beer only 20 yards or so from where it's grown.

We pick and dry the hops, keeping some back in pristine condition for later brewing in six months' time. We're a craft brewery and so we use fantastic quality ingredients and traditional brewing techniques to get the desired taste and strength.

THE GROVE GIN

The Grove Gin idea and process started in 2021 and launched April 2022.

Created by Puddingston Distillery.

The Grove created 250ml and 500ml bottles (available for sale in 500ml bottles – coming soon)

Can find The Grove Gin in some delicious cocktail recipes that feature on our Glasshouse, Stables and Lounge bar menus

THE GROVE HONEY

We currently have 5 hives, but we are hoping to have 6 to 8 by the end of the summer. As each hive becomes stronger we can split them and create more, thus growing our hives and producing more honey.

Firstly, the bees cross pollinate, which is needed for plants to reproduce and for fruit to grow – essential for our estate to plate ethos! We actually have Mason bees at The Grove as well, which are the most endangered type of bee and without them we would have no fruit and veg.

To make sure they flourish, we've ensured there are plenty of plants nearby that produce nectar, such as wildflowers or lime trees; these plants can actually influence the taste of the honey.

SCAN QR CODE TO FIND OUT MORE



Ralph Trustees Ltd Commitment

Ralph Trustees Ltd will comply with all relevant legislation and regulations, and strive to achieve international best practice.

To deliver this, we will:

Support local products, Business and suppliers

Establish and report on key environmental performance indicators

Minimize waste and optimize waste management

Develop a culture within the business that recognises the need to use energy resources efficiently and promotes the development and implementation of ideas throughout the business

Develop and evaluate operational policies to identify changes that could be implemented to deliver our services with lower energy use

Identify areas of waste or inefficiency that we can remove or reduce

Maintain our major equipment to ensure energy is used efficiently

In parallel we also need to:

Invest in cost effective new technologies with reduced energy requirements and carbon emissions

Improve our buildings' performance to reduce energy demands



EVENT HOSTING

The Grove successfully hosts many demanding high-profile events, from global tech corporations and top financial institutions, to international sports teams. The Grove team love to run events that push their boundaries and allow them to deliver great service whilst running new activities and concepts. Events this year have seen complete transformations of the meeting spaces, three-week builds for marquees, and the construction of a glass building lifted into the Walled Garden with cranes, complete with a meeting auditorium, breakout rooms, toilets, a café and much more.

A further example of this dedication was the NATO Summit in December 2019, an event where world leaders gathered at The Grove with 2,000 members of the international press. This could not have been achieved as successfully as it was without the high standards and team work. The relationship built with the Foreign Office, Herts Police and NATO enabled the team to deliver a flawless 24 hours, of which months of intricate planning, meetings, show-arounds and tastings enabled The Grove to deliver one of the largest operations Hertfordshire had seen.



EXPERIENCE UNFORGETTABLE MOMENTS AT THE GROVE



To view the video, click the interactive image above.

